

DEPEND ON  
**DAVEY**

**WATER PRODUCTS**

# SHALLOW WELL JET AND VENTURI KIT

## Introduction

(Read these instructions fully before commencing installation)

These instructions detail the fitment of replacement Jet and Venturi components to Davey Pressure Pump Models 95S, 125S and 165S to achieve higher than standard operating pressure (refer Performance Table for details).

If you have any difficulties with your installation, or require further advice, contact the Davey Dealer from whom you purchased this kit.

Each Shallow Well Jet Kit contains one Jet and one Venturi with Oring.

Pump Model	Jet Kit Model	Jet Part No.	Venturi Part No.	Operating Pressure	
				kPa	psi
95S	691	8816-8 (Brown)	9952-33 (White)	340	49
125S	694	8816-5 (Green)	9952-38 (Brown)	340	49
125S	695	8816-9 (Yellow)	9952-33 (White)	410	59
165S	698	8816-6 (Red)	9952-43 (Red)	340	49
165S	699	8816-6 (Red)	9952-36 (Green)	480	70

## Procedure

1. Check that you have correct components by verifying the component colour and Part Number moulded into Jet and Venturi (refer Table above for identification).
2. If pump already installed, then turn off power and water supply. Drain water from pump.

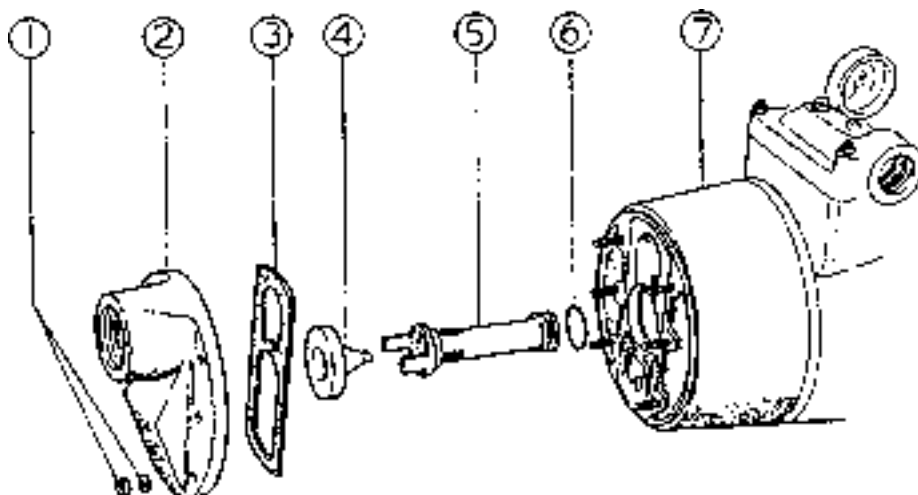

3. Remove 6 nuts and washers (Item 1) from suction cover, then remove suction cover (Item 2) and gasket (Item 3).
4. Withdraw existing jet (Item 4) and venturi (Item 5) from pump housing (Item 7).
5. If pump already installed, flush clean housing to remove any foreign material.
6. Ensure oring (Item 6) is fitted to venturi in correct position, then insert venturi into housing, being sure to locate the two legs as shown in illustration i.e. with pump and motor on horizontal plane. Legs should be in horizontal position.

7. Fit jet into housing.
8. Refit gasket (Item 3) into suction cover (Item 2), tighten nuts.

Note: (a) Flat section of jet must be flush with surrounding area. If jet not seated correctly, re-check venturi and correct positioning.

- (b) When re-fitting gasket, be sure to fit gasket on two locating pins provided at top of housing.
- (c) Be careful when tightening nuts to avoid stripping threads.

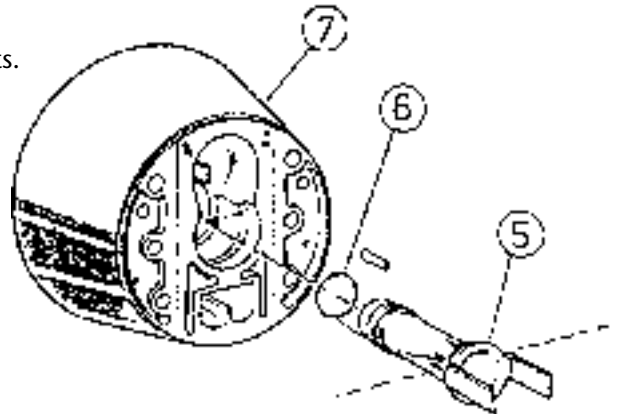

9. Attach jet identification label to suction cover.

10. If pump already installed as Pressure System, re-adjust pressure switch cut-in and cut-out settings as per Table for this kit. Also adjust tank air pressure pre-charge (refer tank label).

11. Re-prime and operate pump as per Installation and Operating Instructions supplied with pump.

Note: Adjust gate valve at pump outlet so that pressure does not fall below operating pressure (refer Table) when all outlet taps are open.

Pump Model	Jet Kit Model	Operating Pressure		Pressure Switch Setting when Installed as an Automatic Pressure System			
		kPa	psi	kPa		psi	
		Cut-in	Cut-out	Cut-in	Cut-out	Cut-in	Cut-out
95S	690*	260*	38*	260*	380*	38*	55*
	691	340	49	340	510	49	74
125S	693*	260*	38*	260*	380*	38*	55*
	694	340	49	340	510	49	74
	695	410	59	410	590	59	85
165S	697*	260*	38*	260*	380*	38*	55*
	698	340	49	340	510	49	74
	699	480	70	480	660	70	96

\* Standard configuration. NB. 'psi' figures are an approximation of the kPa figures.

Davey may be collecting personal information from you in order to provide you with a service. Davey Water Products Pty Ltd promises only to use this information in accordance with the Provisions of the Privacy Act 1988 (Cth) and the Privacy Policy of Davey Water Products Pty Ltd which is available at [davey.com.au](http://davey.com.au).

© Davey is a registered trademark of Davey Water Products Pty Ltd. © Davey Water Products Pty Ltd 2005.



**Davey Water Products Pty Ltd**

Member of the GUD Group  
 ABN 18 066 327 517  
**Head Office and Manufacturing**  
 6 Lakeview Drive,  
 Scoresby, Australia 3179  
 Ph: +61 3 9730 9222  
 Fax: +61 3 9753 4100  
 Website: [davey.com.au](http://davey.com.au)  
**Customer Service Centre**  
 Ph: 1300 367 866  
 Fax: 1300 369 119  
 E-mail: [sales@davey.com.au](mailto:sales@davey.com.au)  
**Interstate Offices**  
 Sydney • Brisbane • Adelaide  
 Perth • Townsville

**International**

6 Lakeview Drive,  
 Scoresby, Australia 3179  
 Ph: +61 3 9730 9121  
 Fax: +61 3 9753 4248  
 E-mail: [export@davey.com.au](mailto:export@davey.com.au)

**Germany**

Kantstrasse 53,  
 04275 Leipzig  
 Ph: +49 341 301 0412  
 Fax: +49 341 301 0413  
 E-mail: [akrenz@daveyeurope.com](mailto:akrenz@daveyeurope.com)

**New Zealand**

2 Rothwell Avenue,  
 North Harbour, Auckland 1330  
 Ph: +64 9 914 3680  
 Fax: +64 9 914 3685  
 Website: [daveynz.co.nz](http://daveynz.co.nz)  
 E-mail: [sales@daveynz.co.nz](mailto:sales@daveynz.co.nz)

**USA**

**Davey Pumps Inc.**  
 1005 N. Commons Drive  
 Aurora, Illinois 60504  
 Ph: +1 630 898 6976  
 Fax: +1 630 851 7744  
 Website: [daveyusa.com](http://daveyusa.com)  
 E-mail: [sales@daveyusa.com](mailto:sales@daveyusa.com)